

35147 BEACH ROAD

102

101

1 SPEED BUMP/5  
USH W/AC

STREET RIGHT OF WAY 30'

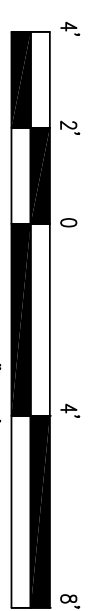
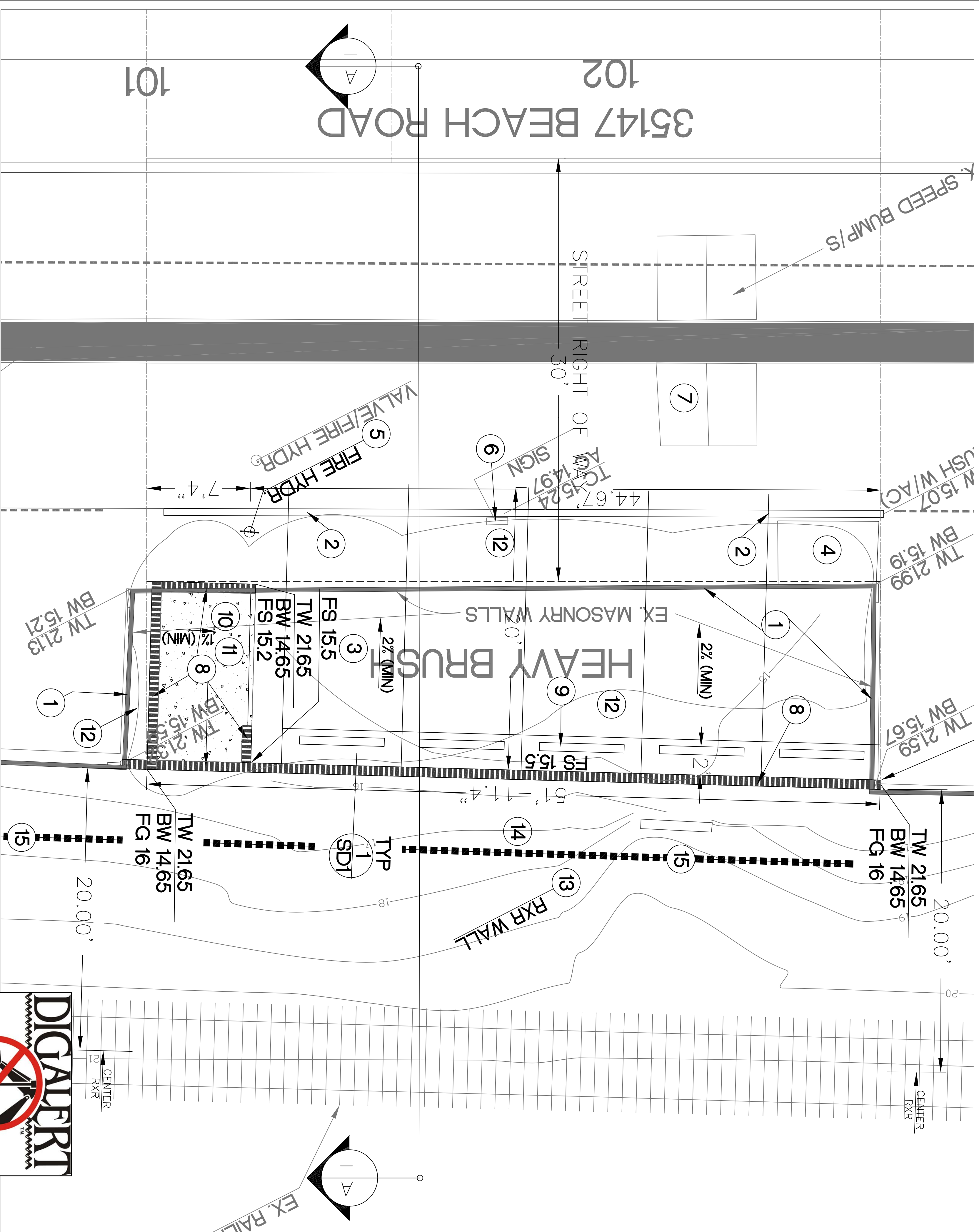

**DIGALERT**  
800-227-2600  
Call 2 Full Working Days in Advance  
REQUIRES A DIGALERT IDENTIFICATION NUMBER  
BE ISSUED BEFORE ANY EXCAVATION  
STARTS. A VENDOR IDENTIFICATION NUMBER  
MAY BE OBTAINED BY CALLING THE  
CALL UNDERGROUND SERVICE ALERT

SECTION 10 OF THE GOVERNMENT CODE  
REQUIRES A DIGALERT IDENTIFICATION NUMBER  
BE ISSUED BEFORE ANY EXCAVATION  
STARTS. A VENDOR IDENTIFICATION NUMBER  
MAY BE OBTAINED BY CALLING THE  
CALL UNDERGROUND SERVICE ALERT

DESIGNED BY: DONALD S. RUSSELL, CEM  
CHECKED BY: STEPHEN PETER, CEM  
DATE: 12/21/14

BENCHMARK: OCSM 38-50-68  
ELEVATION = 16.995  
NAVD 88/DATUM

**NOTES:**

NOTE 1) SCRRRA IS NOT A MEMBER OF DIGALERT. THE CONTRACTOR SHALL CALL SCRRRA'S SIGNAL DEPARTMENT AT (909)899-4100 A MINIMUM OF FIVE DAYS PRIOR TO BEGINNING CONSTRUCTION TO MARK SIGNAL AND COMMUNICATION CABLES AND CONDUITS. TO ASSURE CABLES AND CONDUITS HAVE BEEN MARKED, NO WORK MAY PROCEED UNTIL YOU HAVE BEEN PROVIDED WITH AN SCRRRA DIG NUMBER. IN CASE OF SIGNAL EMERGENCIES OR GRADE CROSSING PROBLEMS, THE CONTRACTOR SHALL CALL SCRRRA'S 24-HOUR SIGNAL EMERGENCY NUMBER 1-888-446-9721."

NOTE 2) CONTRACT SCRRRA'S CONSULTANT/CONTRACTOR AT (714) 920-9037 TO ARRANGE FOR FLAGGING SERVICES. FLAGGING SERVICE IS DEPENDENT ON THE EMPLOYEE-IN-CHARGE(EO) AVAILABILITY AND MAY REQUIRE A MINIMUM OF FIFTEEN WORKING DAYS PRIOR TO BEGINNING WORK. PRIOR NOTIFICATION OF FLAGGING SERVICES DOES NOT GUARANTEE THE AVAILABILITY OF THE EIC FOR THE PROPOSED DATE OF WORK.

NOTE 3) CONTRACT SCRRRA'S CONSULTANT/CONTRACTOR AT 1-877-452-0205 TO ARRANGE FOR THIRD PARTY SAFETY TRAINING. ALLOW 24 TO 72 HOURS FROM THE REQUEST FOR SAFETY TRAINING TO ARRANGE THE TRAINING.

NOTE 4) ANY PROPOSED EXCAVATION THAT MAY OCCUR IN SCRRRA RIGHT-OF-WAY OR THAT MAY AFFECT OPERATIONS ON SCRRRA TRACKS MUST ADHERE TO THE DESIGN, SUBMITTAL AND REVIEW REQUIREMENTS PRESENTED IN SCRRRA'S EXCAVATION SUPPORT GUIDELINES AND SHALL NOT PROCEED WITHOUT ACCEPTANCE BY SCRRRA. THE GUIDELINES ARE AVAILABLE ON SCRRRA'S WEBSITE: WWW.METROLINKTRAINS.COM ("ABOUT US", AND "ENGINEERING AND CONSTRUCTION")

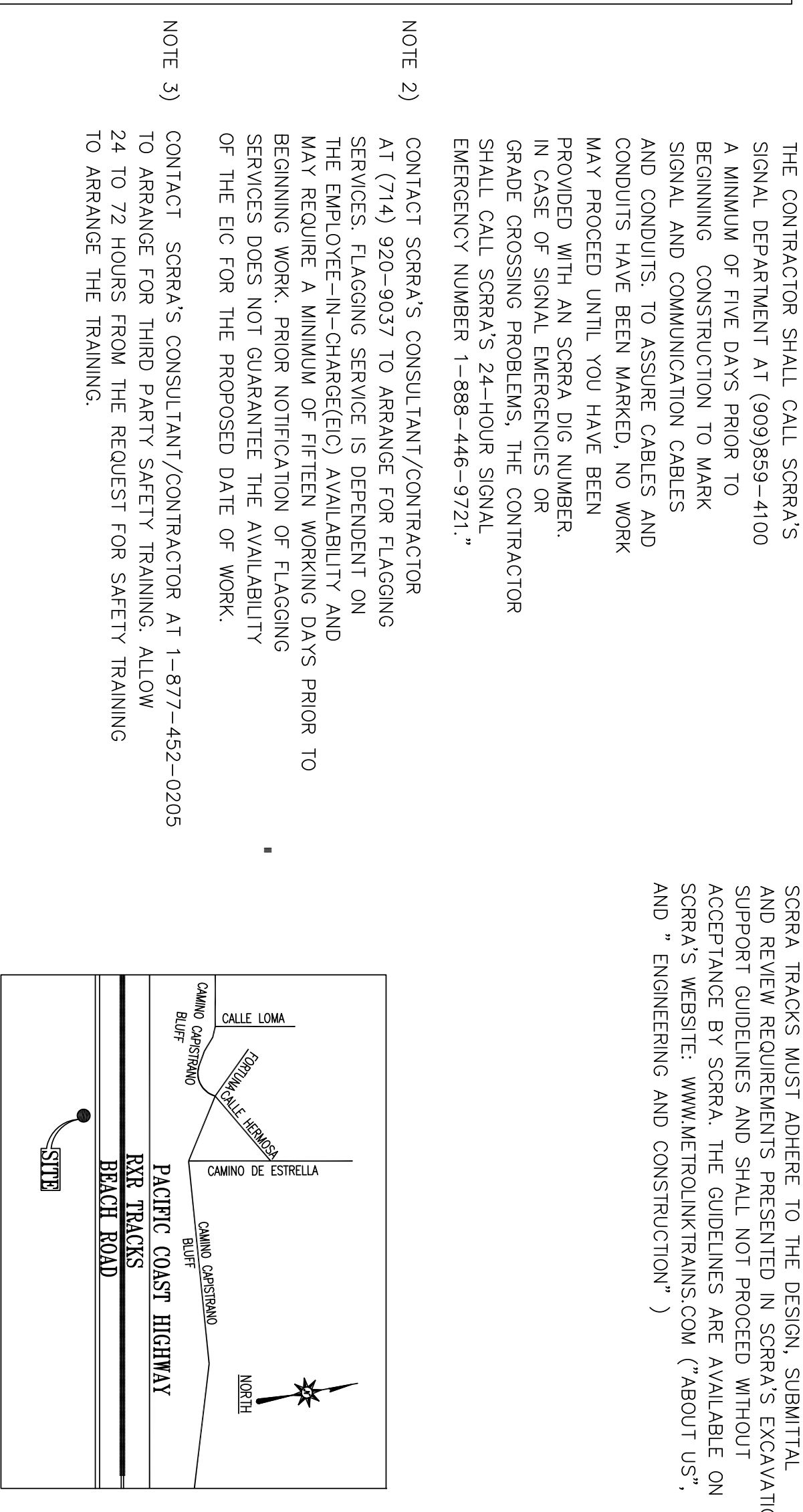

**CONSTRUCTION NOTES:**

- 1 REMOVE EXISTING MASONRY WALLS 80 L.F. (+/-)
- 2 GRIND EXISTING CURB LEVEL WITH EXISTING ASPHALT 51 L.F. (+/-)
- 3 REMOVE EXISTING VEGETATION AND ANY DEBRIS 1 EA
- 4 REMOVE EXISTING TRASH ENCLOSURE 1 EA
- 5 PROTECT FIRE HYDRANT 1 EA
- 6 REMOVE SIGN 2 EA
- 7 REMOVE EX. TRAFFIC SPEED BUMPS AND REPLACE TO NEW LOCATION PER OBCSD 100 L.F. (+/-)
- 8 CONSTRUCT NEW MASONRY WALLS PER PLAN. EXPOSED HEIGHT OF WALLS NOT TO EXCEED 6 FT. 5 EA
- 9 INSTALL CAR STOPS
- 10 CONSTRUCT NEW TRASH/STORAGE AREA 78 S.F. (+/-)
- 11 CONSTRUCT CONCRETE FLATWORK: 4-IN. MINIMUM THICKNESS W/#3 REBAR AT 24" O.C. EA. WAY. 880 S.F. (+/-)
- 12 CONSTRUCT ASPHALT CONCRETE: 4" AC OVER 6" BASE. COMPACT BASE AGGREGATES TO 95% OF MAXIMUM DENSITY AS DETERMINED BY ASTM D1557 TEST METHOD. ALL SUBGRADE SOILS TO BE COMPACTED AT 90% OF MAXIMUM DENSITY AS DETERMINED BY ASTM D1557 TEST METHOD. ENGINEER, DEPTH OF SUBGRADE SOILS REMOVAL AND RECOMPACTION SHALL BE PER THE GEOTECHNICAL ENGINEER'S RECOMMENDATIONS ONCE ALL EXISTING BASE MATERIALS HAVE BEEN EXCAVATED OFF SITE.
- 13 EXISTING R/R WALL TO REMAIN
- 14 PROTECT EXISTING FIBER OPTIC LINE
- 15 EXISTING FIBER OPTIC LINE. NOTIFY DIG ALERT TO LOCATE LINE AND HAND POT HOLE TO LOCATE EXACT LOCATION. (EXISTING DEPTH OF FIBER OPTIC LINE IS BELIEVED TO BE 48-INCHES BELOW GROUND).

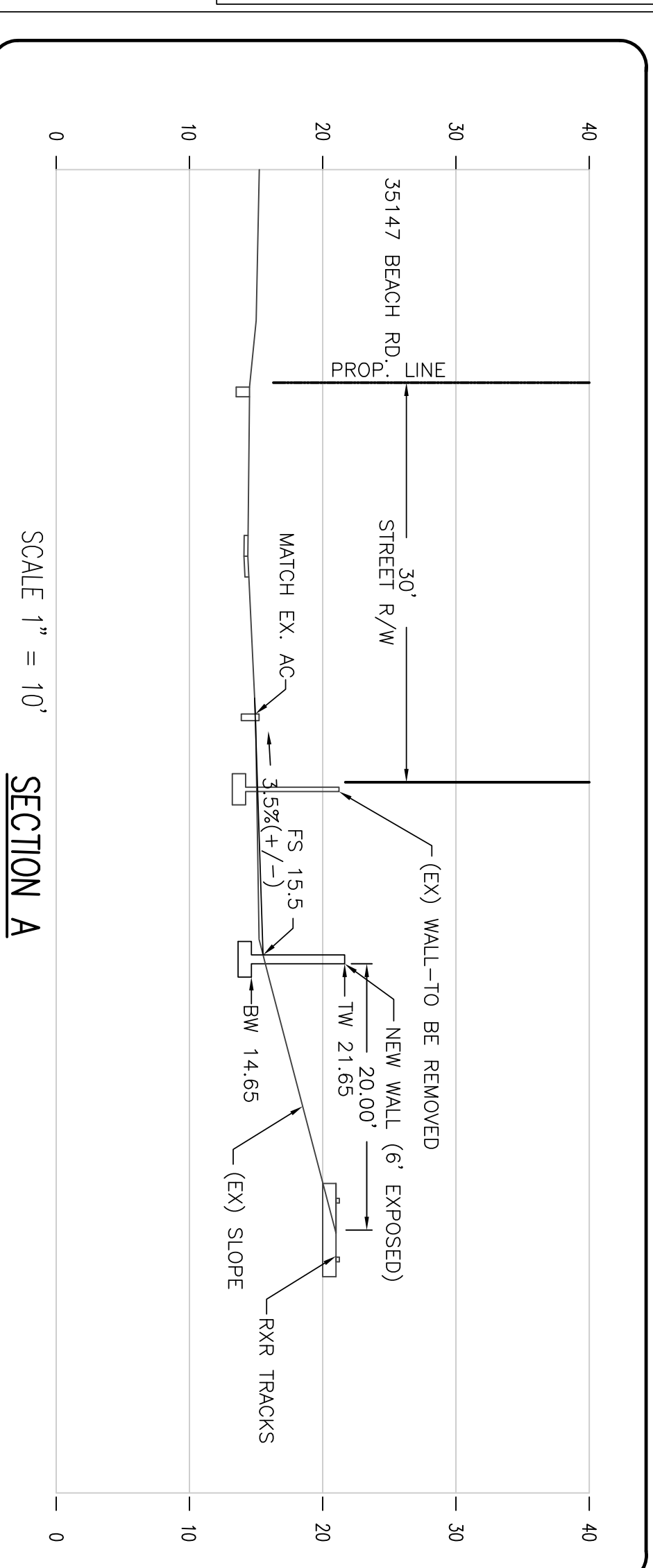

PLANS PREPARED BY: **PETER and ASSOCIATES** ENGINEERS, GEOLOGISTS & SURVEYORS, INC.  
WWW.PETERASSOC.COM  
1519 CALLE WALLE, SAN CLEMENTE, CA 92672  
Tel: (949) 492-3735 Fax: (949) 492-1891

**PARKING IMPROVEMENT PLAN**  
PRELIMINARY PARKING IMPROVEMENT PLAN  
35147 BEACH ROAD  
CAPISTRANO BEACH, DANA POINT 92624  
PLAN CHECK NO. \_\_\_\_\_  
1 of 1 SHEETS